

TAMD103A-A, TAMD103A-A AUX

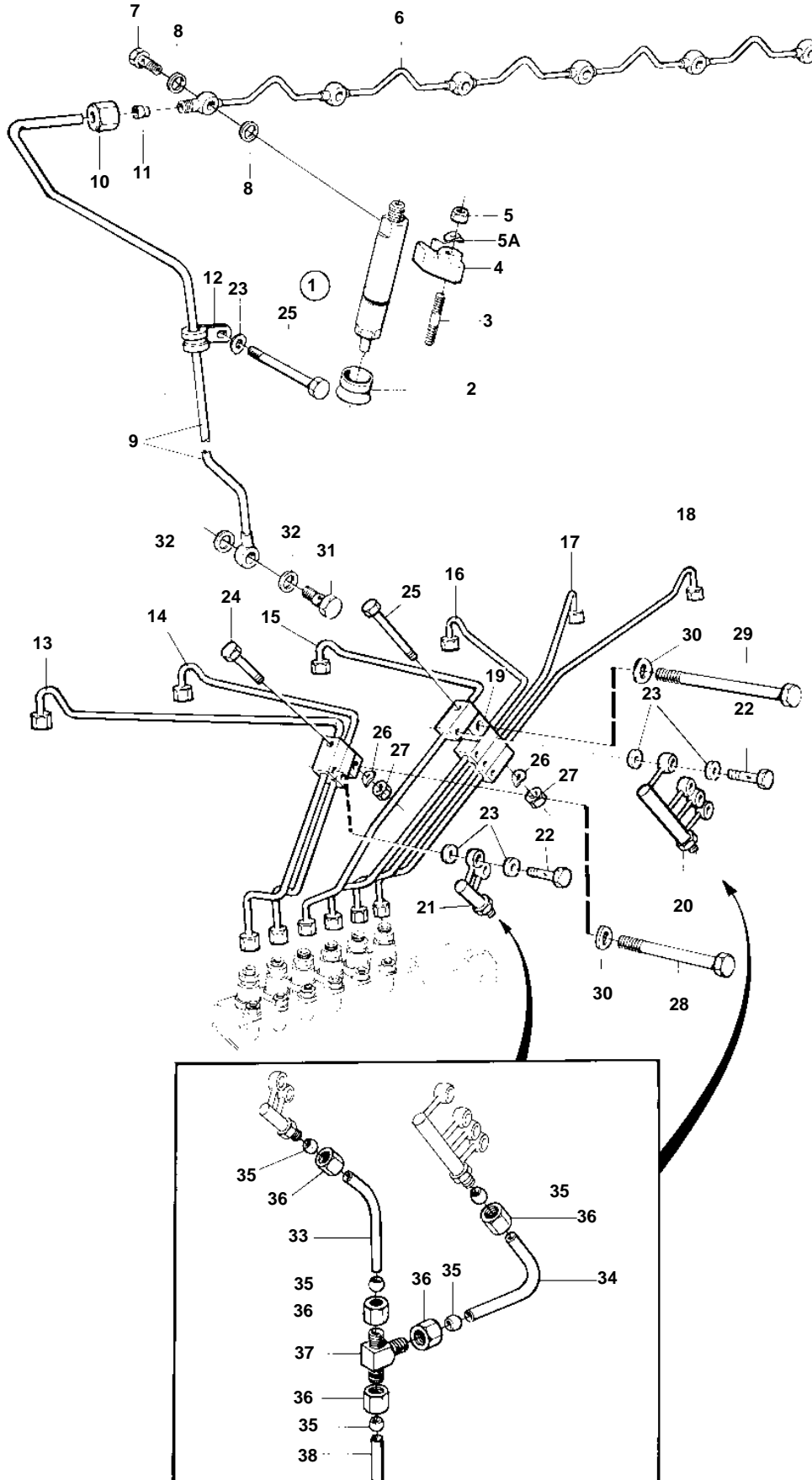

16630

TAMD103A-A, TAMD103A-A AUX

REF	PART NO.	QTY	DESCRIPTION	SEE SEC.	NOTES
1	478606	6	Injector		
	3803281	6	Injector, exch, exch		
				3286	
2	469455	6	Sealing ring		
3	1545022	6	Stud		
4	469797	6	Yoke		
5	971086	6	Lock nut		
5A	942336	6	Spring washer		
6	1545081	1	Leak-off pipe		
7	74033	6	Hollow screw		Included in complete fuel injector.
8	946729	6	Gasket		Included in complete fuel injector.
9	846805	1	Leak-off pipe		
10	956980	1	Fitting nut		
11	956966	1	Ferrule		
12	947191	1	Clamp		
13	848328	1	Pressure pipe		CYL 1
14	848329	1	Pressure pipe		CYL 2, CLASSIFIABLE
15	848330	1	Pressure pipe		CYL 3, CLASSIFIABLE
16	848331	1	Pressure pipe		CYL 4, CLASSIFIABLE
17	848332	1	Pressure pipe		CYL 5, CLASSIFIABLE
18	848333	1	Pressure pipe		CYL 6, CLASSIFIABLE
19	848334	1	Tube		
20	848335	1	Tube		
21	845955	1	Pipe		
22	846183	6	Hollow screw		
23	845953	12	Gasket		
24	969357	1	Flange screw		
25	955285	2	Hexagon screw		
26	941906	2	Spring washer		
27	955781	2	Hexagon nut		
28	959799	1	Hexagon screw		L=165mm
29	941252	1	Hexagon screw		L=171mm
30	942336	2	Spring washer		
31	74033	1	Hollow screw		
32	946729	2	Gasket		
33	847268	1	Fuel pipe		
34	847267	1	Fuel pipe		
35	956969	5	Ferrule		
36	956983	5	Fitting nut		
37	957123	1	T-nipple		
38	847269	1	Oil pipe, leak off line		